

# HEINZMAN STREET RODS

1305 North "C" Road  
Phillips, Nebraska 68865  
Phone (402) 886-2275

# '35-'40 FORD CAR & PICKUP

## ENGINE MOUNTING KIT

For small block Chevy, includes bolt on frame adapters, C.E. engine side mounts, thru bolt cushion set, bolts & instructions. C.E. mounts eliminate frame cracking caused by "wedge action" stock Chevy mounts.



**BOLT-IN KIT** ..... 2101 ..... \$105.00  
**WELD-IN KIT** ..... 2101G ..... \$85.00



## CENTER X-MEMBER MODIFICATION TRANSMISSION MOUNTING KIT

Uses original side bracing and full 360 degree design for the strongest support possible. Completely bolt on. The only kit to replace full strength to the X. Bolts and directions included. For S.B. Chevy, but other engine-transmission will work well. Kits with wishbone splitting added have mount welded to bottom plate. These come with all parts needed. Fits TURBO 350, powerglide, 3 & 4 speeds.

'35-'36	ES-2162	\$101.25	'37-40	ES-2167	\$110.00
'36-'36 w/wishbone kit	ES-2163	\$153.75	'37-40 w/wishbone kit	2168	\$169.50

## DROPPED FRONT AXLES

Chassis Engineering forged I-Beam axle is 47" between King Pin centers and is narrower between perch bolts. Requires special main leaf.



**VINTAGE I-BEAM** ..... \$275.00  
**SPECIAL MAIN LEAF** ..... \$45.00

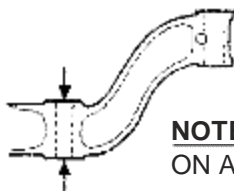

**NOTE:**  
ON ALL AXLES, SPECIFY 2" OR 2 1/2" AXLE BOSS

## FRONT SHOCK KIT 1935-40



Super-Strong — 3 point mounting on upper bracket insures against breakage. Bolt on kit includes all necessary parts: 2 upper brackets, 2 shock absorbers, 2 combination spring shackles and lower shock mounts and all needed bolts and instructions.

WILL NOT WORK ON 1940 WITH STOCK SWAY BAR.

**FRONT SHOCK KIT** ..... AR-2037 ..... \$151.00  
**WITH CHROME SHOCKS** ..... AR-2037C ..... \$171.00

# '35-'40 FORD

## HEINZMAN STREET RODS

1305 North "C" Road  
Phillips, Nebraska 68865  
Phone (402) 886-2275

### FRONT CROSSMEMBER

Weld in replacement for the 1935-1940 Fords. Clears fuel pump on the Chevrolet V8. For use with CE Easy Rider or original suspension.

Part No. AU-2235 ..... \$85.00

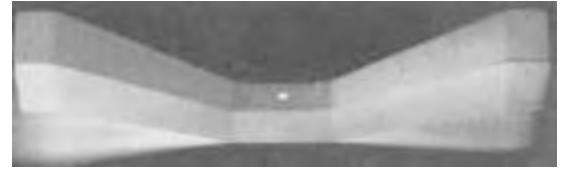

### RADIATOR MOUNTS

State year of car. Use with our crossmembers on stock or repro frames. Stock crossmembers may need slight fitting.

1935-39 Std. / Stock Crossmember, AU-2250A ..... \$49.95 pr.  
1935-39 Std. / Stock Crossmember, AU-2250B ..... \$49.95 pr.  
1939 Dix.-40 / Stock Crossmember, AU-2250C ..... \$49.95 pr.  
1939 Dix.-40 / I. F. S. Crossmember, AU-2250D ..... \$49.95 pr.

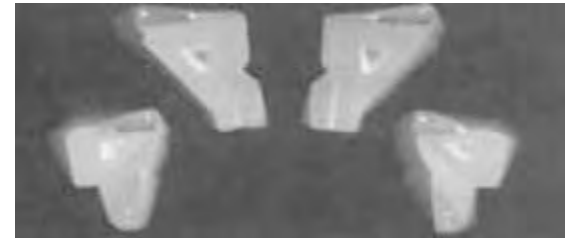

### 1935-1940 BOXING PLATES

Boxing plates are 3/16" thick steel. Two plates per kit, R&L.

Front, Stock Frame, Stock Crossmember, AR-2280 ..... \$47.25 pr.  
Front, Stock Frame, Mustang II Crossmember, AR-2281 ... \$47.25 pr.  
Rear, Stock Frame, AR-2284 ..... \$63.00 pr.



### EASY RIDER FRONT END KITS 1935-40 FORD

All the pieces needed to lower the front end - make it handle and ride super too. Included in this kit is 1. Easy rider spring, (with C.E. sliders), 2. Front shock kit with shackles, 3. Dropped axle, 4. Anti sway bar, 5. New perch bolts, 6. Instructions. A big improvement in driving pleasure. When ordering state engine type and year of wishbone.

NEW - Kit also includes forged dropped spindle arms.  
FK-35-40 ..... \$685.75



### MUSTANG II FRONT SUSPENSION CROSSMEMBER KIT

This kit includes lower crossmember, upper spring mounts, boxing plates, rear strut mounts, boxing plates, rear strut mounts, gussets and instructions to mount '74-'78 Mustang II or '74-'80 Pinto-Bobcat front suspension to your '35 to '40 Ford. Sets the car low and gives a nice ride!

( Note: requires extensive welding)

Complete Kit ..... \$449.00  
Front Sway Bar Kit ..... \$134.50  
Economy Cross ..... \$399.00



# HEINZMAN STREET RODS

1305 North "C" Road  
Phillips, Nebraska 68865  
Phone (402) 886-2275

# '35-'40 FORD

## BOLT ON PINTO I.F.S. FEATURES ADJUSTABLE RIDE HEIGHT

Fully bolt on crossmember uses Pinto or Mustang Suspension components. No bump steer or other unpleasant surprises. Upper coil spring pads are adjustable for ride height, giving a 2 1/2" adjustment at the wheel, and excellent method of fine tuning final ride height to your taste. Center support rods add necessary strength to lower strut rod mount. Interlocking tabs between upper pods and crossmember prevent movement.

**IF-3540FP** (Note: requires engine mount part number CP-2101P) ..... **\$625.00**  
**Installed weld-on option**.....**Add \$85.00**



## FRONT AND REAR SWAY BARS

This is an excellent way to improve the handling and overall drivability of the top heavy Ford. Eliminates road sway. For best results use front and rear bars together. All needed linkage and mounting hardware furnished. An ideal addition for any car.

Front 1935-1936 Also fits 1937-1940 when using early style axle (1928-1936) or C.E. I beam.

..... **SB-3536F** ..... **\$129.50**

Front 1937-1940 Fits later axle (perch bolts are farther apart on 1937-1940 axle).

..... **SB-3740F** ..... **\$129.50**

Front 1935-1940 Use with our 4-bar kit. State type of axle used. (see 4-bar kit).

..... **SB-3540FB** ..... **\$145.00**

Front 1935-1940 Fits Pinto-Mustang IFS kits (also fits many other P-M swaps).

..... **SB-3540PM** ..... **\$134.50**

Front 1935-1940 Fits our Torsion Bar IFS (Highly recommended).

..... **SB-3540TB** ..... **\$145.00**

Rear 1935-1940 Fits C.E. rear end kit (can also be adapted to other cars).

..... **SB-3540R** ..... **\$129.50**

Rear 1935-1940 Axle mounted, fits disc brakes rear like Lincoln Versailles. Very adaptable bar (will work on many other cars).

..... **SB-3540RA** ..... **\$134.50**



**SB-3536F**



**SB-3540FB**



**SB-3540PM**



**SB-3540R**

## PERCH BOLTS

New plain style fits 1935-1948 Ford. Extra long for bolt on lower sway bar mount.

**AR-2210** ..... **\$39.50 pair**  
**Perch Nut** ..... **Ar-2212** ..... **\$5.00 pair**



# '35-'40 FORD

## HEINZMAN STREET RODS

1305 North "C" Road  
Phillips, Nebraska 68865  
Phone (402) 886-2275

### BOLT ON STEERING ADAPTER

This is an excellent change. Mounts GM steering gear, standard or power to '35-'48 Ford. Late column or original may be fitted. Bolts & instructions included.

1935-36 .....	AS-2089 .....	\$53.50
1937-40 .....	AS-2090 .....	\$53.50
1941-48 .....	AS-2094 .....	\$53.50



### MASTER CYLINDER ADAPTER

Bolts Mustang master cylinder to '39-'48 Ford (also '35-'38 using '39-'40 brake pedal assembly). Chevy cylinder can be modified to work. Bolts included.

AS-2021 .....	\$45.00
---------------	---------



### WISHBONE SPLITTING KIT

Bolts to X rails to spread wishbone minimum possible. Uses heavy duty 3/4" truck tie rod ends. Must be welded to wishbone. Bolts and instructions included.

'35-'48 .....	AS-2085 .....	\$100.75
---------------	---------------	----------

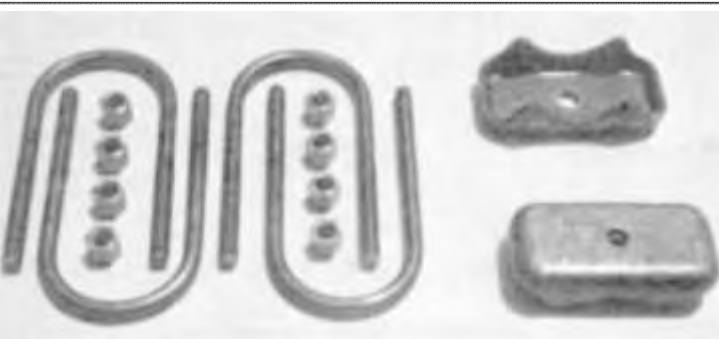

### REAR AXLE SPRING PADS AND LOWERING BLOCKS

Stamped steel replacement axle pads for using when changing spring centers on late rear ends. For 2 1/2' springs.

Axle Pads.....	AU-2229 .....	\$25.00 pr
U-Bolts .....		\$25.00 set
Lowering blocks .....		\$30.00 pr



### "NEW" STREET ROD SPRINGS

Front Main Leaf with Reversed Eyes .....	\$39.50
--	---------

Front, Reversed Eye Spring ... FS-3540F .....	\$129.00
---	----------



Rear Spring for C.E. Dual Leaf Kits RS-3540R .....	\$199.50 pr
---	-------------

# HEINZMAN STREET RODS

1305 North "C" Road  
Phillips, Nebraska 68865  
Phone (402) 886-2275

# '35-'40 FORD

## REPLACEMENT X MEMBER KIT

Formed channel X member gives excellent rigidity for Fiberglass or steel bodies. Ideal for open cars but works well under closed cars too. Fits stock or repro frames. kits have room for most engine combinations. Will fit under stock bodies but is not an exact stock replacement. X member is opened up for transmission clearance. The front of the X is angled. Floor pan will bolt down like stock. Two side braces replace stock items, not included with kit. Requires a C.E. brake pedal. Note: recommended for experienced builders only.

- X-rails ..... AT-2036 ..... \$202.00
- Center transmission mount - Chevrolet 350-etc.  
..... ES2140 ..... \$103.00
- Side braces from frame to C.E. x member center.  
..... ES-2141 ..... \$65.00



## BODY MOUNTS

These are replacements for those missing or rusted body mounts on the outside of the 1935-1940 Ford frame (weld on)

- Contains all 4 mounts ..... AR-2060 ..... \$115.00
- Front OR Rear (Per Pair) ..... \$65.00



## BOLT ON BODY MOUNTS

- Front L or R ..... \$60.00 each
- Rear L or R ..... \$60.00 each

## BRAKE PEDAL KIT 1935-40

Bolt on brake pedal and mounting kit. Mounts Mustang master cylinder (Chev. cylinder can be modified to work). Bolts and instructions included.

- AS-2040 ..... \$135.00



## DROPPED STEERING ARMS

Fits 1935-1948 Fords. New C.E. forged arms are prebent to fit with dropped axles. Choice of Standard or Milled leg for disk brake adapter clearance.

- AR-2121S ..... \$109.00
- Milled for GM Brake Kit ..... \$127.00

# HEIDT'S SUPERIDE™ IRS



The Ultimate Rear Suspension from Heidt's. Uses 9" Ford 3rd Member, Wilwood Inboard Brakes, Aldan Coil Overs and standard widths from 55" to 62". Several options available.

- Complete Hub to Hub. ... \$4295.00

# '35-'40 FORD

## HEINZMAN STREET RODS

1305 North "C" Road  
Phillips, Nebraska 68865  
Phone (402) 886-2275

### 1935-40 REAR END MOUNTING KITS

Bolt-in kit adds reinforcing to rear of frame. No modifications of any kind to rear end. Uses two 61-69 Dodge pick-up springs. Kit includes R&L front spring mount, R&L rear spring mount, bolts, general spring information & instructions. This kit uses '74-'78 Ford Granada, '57-'59 Ford or Ford Maverick rear end. '68-'76 Nova rear end also fits but is too wide for many custom wheels. To use other rear ends, matching spring pads can be welded on.



- '35-'36 Car Only ..... AS-2014 ..... \$140.75
- '35-'41 Pickup & '37-'40 Car ..... AS-2016 ..... \$140.75
- Complete Kit w/ Springs and all parts required ..... \$478.00
- Spacer Kit w/ Spring Kit ..... AR-2070A ..... \$25.00



### REAR SHOCK KIT

Includes 2 lower spring retainer plates and shock mounts, 2 upper shock mounts, bolts and instructions. Use with our rear end kits only.

- '35-'40 ..... AR-2038A ..... \$69.50
- '41-'48 Car Only ..... AR-2049 ..... \$69.50



### REAR SHOCKS

- Special Valving Shock ..... AU-2219 ..... \$49.75 pr.
- Gas Filled Shock ..... AU-2219G ..... \$67.95 pr.

### POWER BRAKE ADAPTER

Adapts Pinto power booster to stock 1939-1940 or C.E. pedal assembly. May need X-member alterations for clearance.



- 1939-1940 Pedal ..... AS-2051 ..... \$57.50
- C.E. pedal ..... AS-2052 ..... \$57.50



### SHACKLES

- Standard, Front, 2" ..... 3321F ..... \$39.00 pr.
- '35-'48 Rear End Kit ..... AU22-14 ..... \$30.00 pr.

# HEINZMAN STREET RODS

1305 North "C" Road  
Phillips, Nebraska 68865  
Phone (402) 886-2275

# '35-'40 FORD

## HEIDT'S SUPER RIDE II

Give your Fat Fendered Ford a smooth ride, good handling, and the ultimate look with Heidt's Spuperide II - A complete front suspension kit which includes : main crossmember, dropped spindles, adjustable tubular A-arms, adjustable coil over shocks with chrome springs, 11" disc brake vented rotors, billet calipers or GM calipers, front mounted rack and pinion steering, and factory ball joints & tie rod ends.

OPTIONS AVAILABLE: stainless steel, control arms, power rack & pinion, sway bar, polished shocks and polished calipers.

Available for the following:

**'35-'40 Ford Car/Pick-up**

**\$2395.00**

**'41-'48 Ford ..... \$2695.00**

**'53-'56 Ford Pick-up ..... \$2695.00**

**'55-'59 Chevy Pick-up ..... \$2695.00**

**'37-41 Willys ..... \$2695.00**

**Polished Stainless Steel Package ..... \$499.00**



## TRIANGULATED LADDER BAR KIT

- Mounts rear end end into '35 to '40 Ford
- Prewelded Crossmember Assembly welds into stock x-member
- Urethane Bushings at front center pivot
- Adjustable Clevis at rear
- ultimate in strength and traction  
(specify housing diameter)

**'35-'40 ..... 5011 ..... \$395.00**

**(Drag Race Version) ..... 5011DR ..... \$439.00**

**'42-'48 ..... 6011 ..... \$395.00**



## REAR COIL OVER SUSPENSION KIT

Tube crossmember replaces stock crossmember using stock rivet holes in frame for location and easy installation. Boxing plates, upper shock mounts, panhard bar brackets welded to crossmember. Lower shock mounts have 3 positions to adjust ride height. Panhard bar axle bracket welds to back side of rear end housing.

**'35-'40 ..... 5013 ..... \$299.00**

**'42-'48 ..... 6013 ..... \$299.00**

**AldanCoil Overs ..... 658 ..... \$379.00**

(spring rates: 130#, 160#, 190#, 220#, 250#, 300#, 350#)

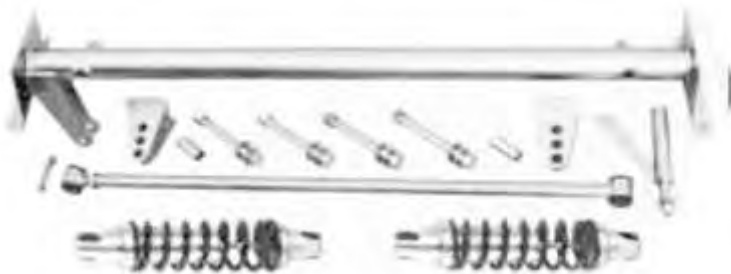

## UNIVERSAL REAR SHOCK KIT

- Brackets have 4 vertical positions to dial-in shock travel
- Features Pete & Jakes Rod shocks
- Includes shock studs and upper brackets

**'35-'40 ..... 1070 ..... \$104.00**

**'41-'48 ..... 1073 ..... \$110.00**



# '35-'40 FORD

## HEINZMAN STREET RODS

1305 North "C" Road  
Phillips, Nebraska 68865  
Phone (402) 886-2275

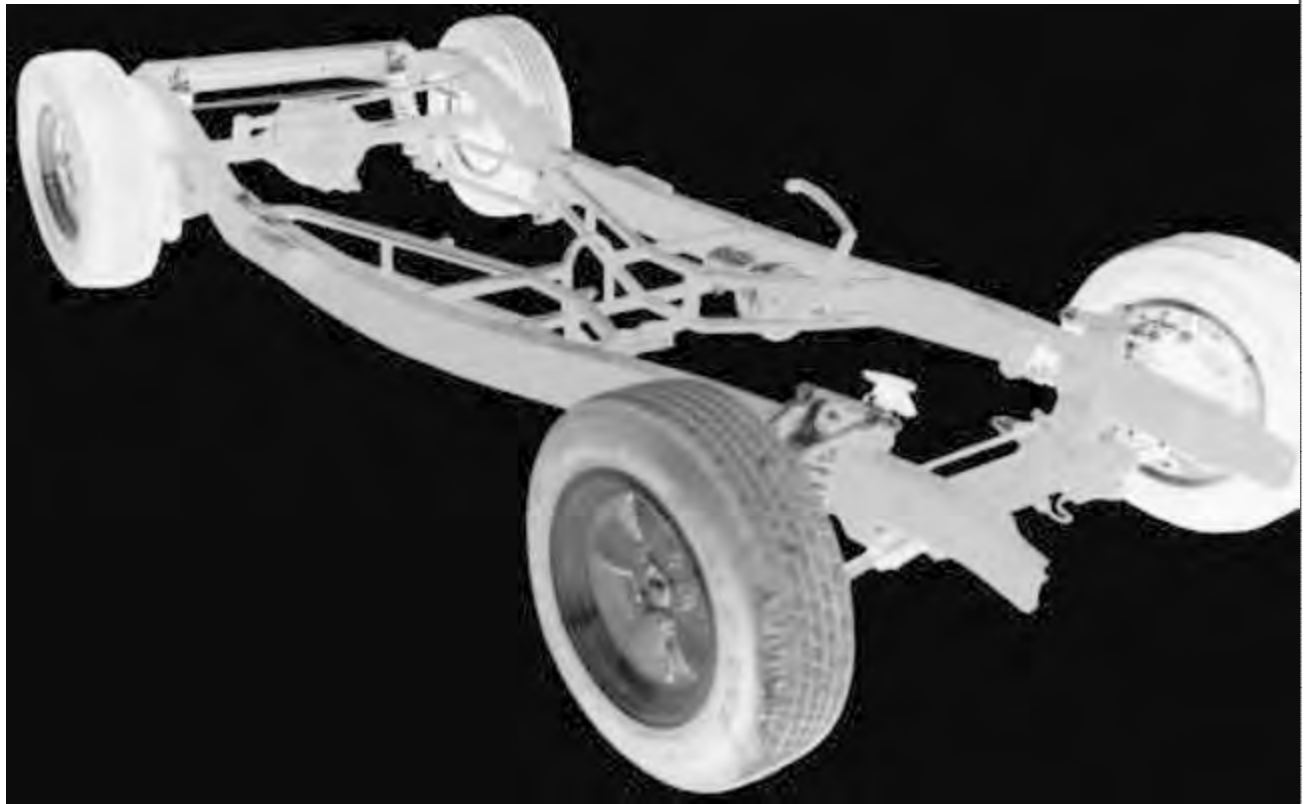

### '35 to '40 REPRODUCTION CHASSIS

#### Frame Comes Standard With:

- 10 gauge rails built in a super accurate jig.
- Fully boxed new rails for strength and appearance.
- All mounting holes have weld nuts installed.
- Universal transmission mount accepts several motor transmission combinations.
- Tubular X-member is 1 1/2" diameter x .120 wall welded at 12 points.
- Body Side mounts installed on outside of frame rails.
- Mustang II Cross member installed

**Base Price ..... \$2795.00\***

Several engine and transmission choices.  
Several rear suspension choices: leaf spring, coil overs, 4-link. Some parts available in Stainless Steel. Mustang II, SuperRide II, or Dropped Axle front suspension available

**\* Rolling Chassis w/ Mustang II, 8" RR .. \$5250.00**

Note: We can use your original frame – Call for information

#### Price as pictured with:

- Super Ride II Frt Suspension
  - Frt / RR Sway Bars
  - Engine Mounts
  - 9" Ford Rear Housing / Axles
  - Coil- Overs / 4 Link RR suspension
  - Power Boosted Master Cylinder / Brake Pedal
- ..... \$7635.00

#### OPTIONS

- 9" Gear Case (any ratio) ..... \$525.00
- Traction Lok ..... \$450.00
- Rear Drum Brakes ..... \$325.00
- Rear Disc Brakes ..... (several choices)
- Brake Line Package ..... \$600.00
- Chassis Paint ..... \$800.00
- Polished S/S A-Arm Package ..... \$499.00
- Power Steering ..... \$50.00

# HEINZMAN STREET RODS

1305 North "C" Road  
Phillips, Nebraska 68865  
Phone (402) 886-2275

# '35-'40 FORD

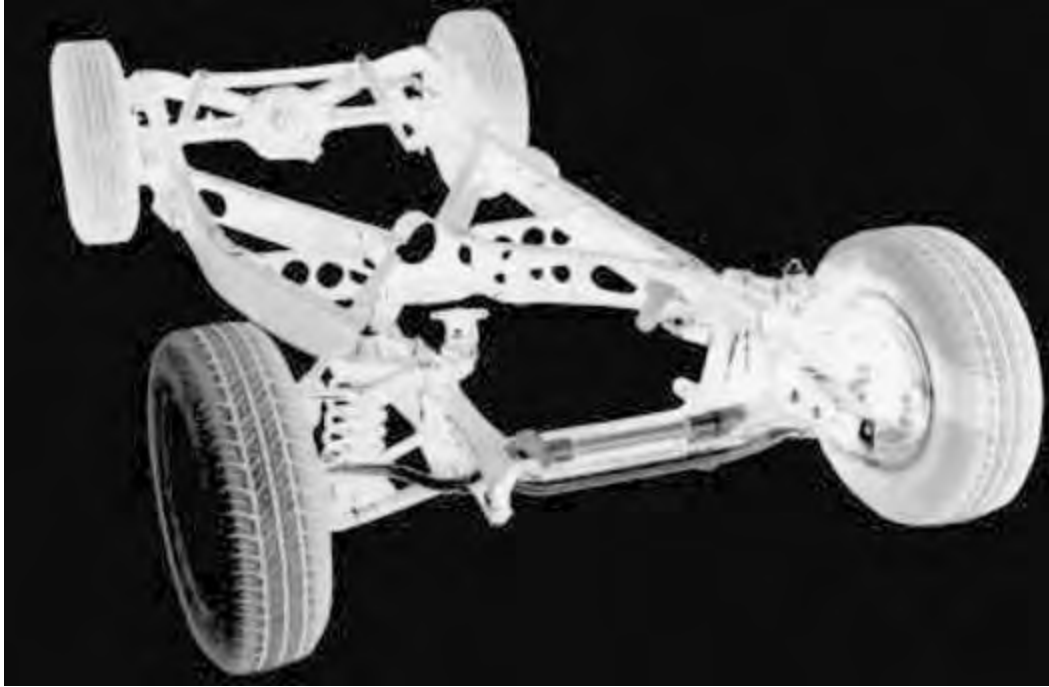

## '35 to '40 FORD: FRAME EXCHANGE PROGRAM

**\*\* TRADE IN YOUR ORIGINAL FRAME FOR A READY-TO-ROLL STREET ROD CHASSIS\*\***

\*\*Includes the following:

- An original '35 to '40 Ford Frame (sandblasted, repaired and primed)
- Mustang II Front Suspension. Includes: new 5-Bolt Rotors, Shocks, Springs, Spindles, and a Manual Rack & Pinion Steering Gear.
- Heidt's Mustang Crossmember Kit and Tubular A-Arms
- Front Sway Bar
- Small Block Chevy or Small Block Ford Front & Rear Motor Mounts
- 8" Ford Rear End (9" Ford Rear End available)
- Chassis Engineering Parallel Leaf Spring Rear Suspension
- Rear Sway Bar

**\*\*Ready for your Wheels and Tires ..... \$4150.00**

**\*\*Chassis are also available outright without trade-in (Core Charge \$500.00)**

### ADDITIONAL OPTIONS

Heidt's SuperRide II™ Suspension .....	\$895.00
Narrowed 9" Ford Housing / Axles .....	\$600.00
Pete / Jake's Ladder Bars w/ Aldan Coil Overs .....	\$595.00
Complete Brake-Fuel System w/ Power Booster Master Cylinder .....	\$1250.00
Gas Tanks-Poly / Coated Steel .....	\$215.00
Gas Tanks-Stainless Steel .....	\$655.00
EFI In-tank Pump .....	\$300.00
Chassis Paint / Body Work .....	\$800.00
9" Ford Gear Case (rebuilt) any ratio .....	\$525.00
Traction Lock .....	(call for quote) Add \$450.00
Power Rack & Pinion Steering Gear .....	\$100.00
Overdrive Trans X-Member Modification .....	Included

# '35-'40 FORD

## HEINZMAN STREET RODS

1305 North "C" Road  
Phillips, Nebraska 68865  
Phone (402) 886-2275

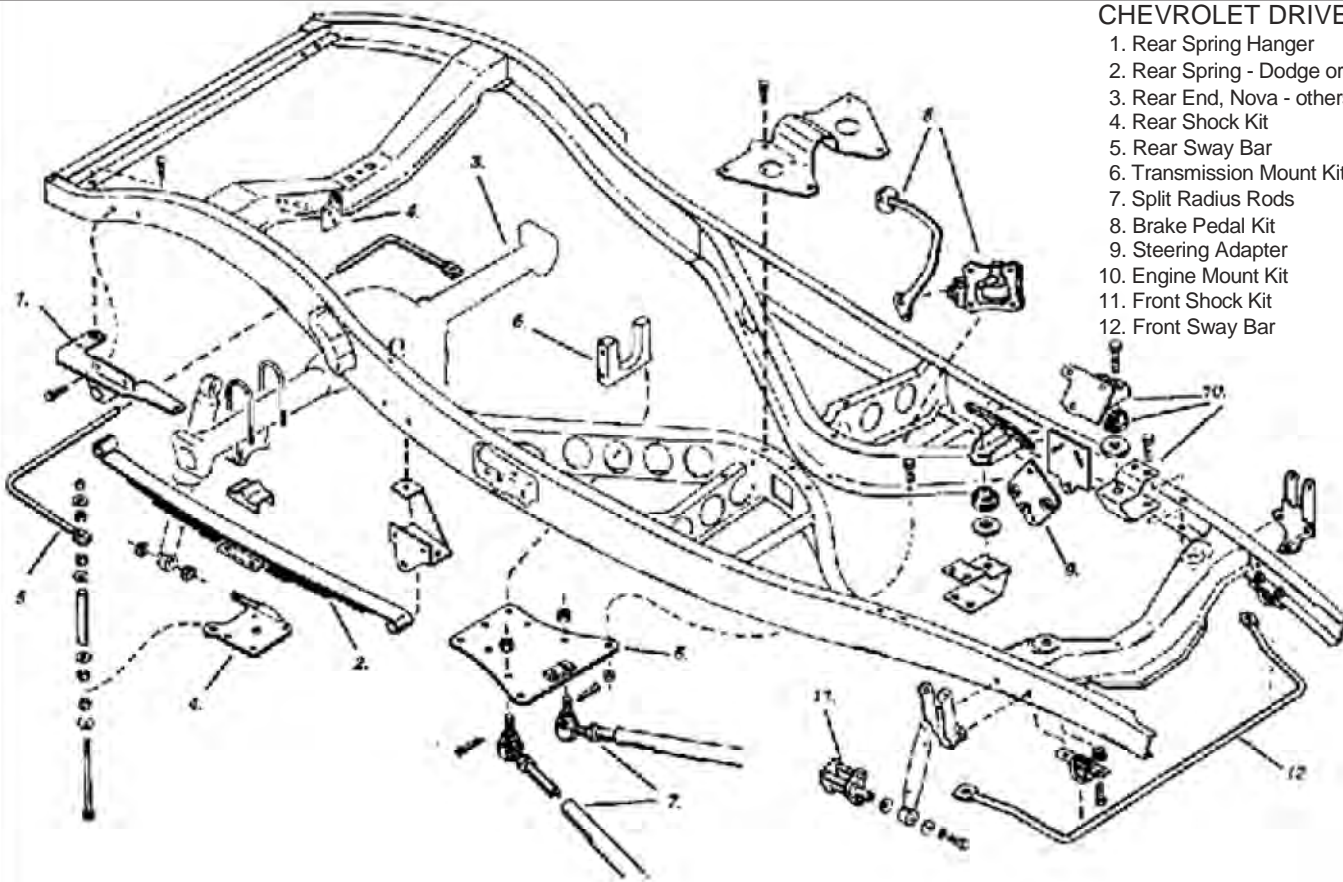

- CHEVROLET DRIVETRAIN**
1. Rear Spring Hanger
  2. Rear Spring - Dodge or C.E. Slider
  3. Rear End, Nova - others
  4. Rear Shock Kit
  5. Rear Sway Bar
  6. Transmission Mount Kit
  7. Split Radius Rods
  8. Brake Pedal Kit
  9. Steering Adapter
  10. Engine Mount Kit
  11. Front Shock Kit
  12. Front Sway Bar

### SMALL BLOCK FORD ENGINE MOUNT

#### ENGINE MOUNTING KIT

Includes bolt on frame adapters, frame corner braces, C.E. engine side mounts, thru bolt cushion set, bolts and instructions.

- Bolt on kit (solid axle) ..... CP-2203 ... \$110.00**  
**Bolt on kit (Pinto-Mustang IFS) .... CP-2203PM ... \$110.00**



#### ENGINE MOUNTING KIT

Includes weld on frame adapters, C.E. engine side mounts, thru bolt cushion set, bolts and instructions. Frame must be boxed to use. Generally used with Pinto-Mustang IFS.

- Weld on kit ..... CP-2203G ..... \$90.00**



#### BOLT ON STEERING ADAPTER

Intended for use only with engine swap CP-2203. Adapts Saginaw steering boxes, manual or power, to 1935-1940 Ford with Ford engine. Late column or original may be fitted. One U-joint required. Bolts and instructions included.

- Bolt on Steering Adapter ..... AS-2095 ..... \$65.00**

